



GALAPAGOS TRIBUTE — NOT JUST A CRUISE
A **TRIBUTE** TO CONSCIOUS LUXURY AND TRANSFORMATIVE EXPLORATION



DISCOVER THE GALAPAGOS ISLANDS ABOARD GALAPAGOS TRIBUTE

WHERE REFINED EXPLORATION MEETS PURPOSE



Galapagos Tribute is not merely a yacht — it is a statement of harmony between luxury, sustainability, and discovery. As Ecuador's first sustainable superyacht, this 42-metre vessel offers a new standard in expedition cruising through one of the world's last untouched sanctuaries.

With space for just 16 privileged guests, Tribute combines technical sophistication, versatile design, and a deeply rooted Ecuadorian hospitality to deliver an experience that is both intimate and transformative.

Every journey aboard Tribute is one of purpose and privilege — a conscious way to explore the Galapagos while enjoying unmatched attention to detail and guest satisfaction. Here, comfort meets conservation, and every moment is designed to inspire awe, connection, and care for the natural world.

WHY CHOOSE TRIBUTE?

A NEW ICON OF CONSCIOUS LUXURY CRUISING

1 INTIMACY & SPACE

With just 8 ocean-view suites spread across three spacious decks, Tribute redefines exclusivity — offering privacy without pretense. From the expansive 50 m² Owner's Suite to the elegantly appointed Panorama and Premium Suites, every space invites deep comfort and uninterrupted connection with nature.

2 SILENT CRUISING & SUPERIOR COMFORT

While others sail, Tribute glides in silence. Advanced stabilizers, next-generation soundproofing, and cutting-edge vibration control ensure serene nights and smooth cruising — a rare and refined experience in Galapagos waters.

3 ELEGANT EXPLORATION

Each day brings new adventures led by two expert naturalist guides, offering private excursions by custom tender. Whether hiking volcanic trails, kayaking beside blue-footed boobies, or snorkeling with sea lions, every encounter is immersive, intimate, and expertly curated.

4 TASTE THE LAND

Celebrate the soul of Ecuador with a culinary experience rooted in local terroir. From artisanal chocolate tastings to elegant wines and seasonal menus, each dish is a tribute to flavor, origin, and craftsmanship.

5 WELLNESS AT SEA

Wellness aboard Tribute is not an afterthought — it's woven into every moment. Rejuvenate in the hydro massage spa on the Sky Deck, enjoy open-air workouts, or indulge in private yoga and massage sessions, all set against the backdrop of the Pacific.

6 SUSTAINABILITY AT HEART

Designed from the keel up for low-impact exploration, Tribute features smart, virus-free ventilation, a high-efficiency HVAC system with heat-recovery technology, and energy-saving propulsion. A true pioneer in responsible luxury, she reflects a bold commitment to the preservation of the Galapagos.



YACHT AMENITIES

SOPHISTICATED COMFORT AT SEA



HYDRO MASSAGE SPA

A serene retreat on the Sky Deck, featuring multi-mode body and neck jets, eco-friendly filtration, and ozone purification — designed for deep relaxation with minimal environmental impact.



PANORAMIC SKY DECK

Unwind in shaded or sunlit lounges with 360° ocean views. Enjoy al fresco dining, a gourmet BBQ station, and seamless transitions between exploration and indulgence.



COCKTAIL BAR & LOCAL SNACK CORNER

Savor handcrafted cocktails and curated infusions paired with artisanal local bites — a tasteful celebration of Ecuadorian flavors and hospitality.



WINE VAULT & ECUADORIAN ART COLLECTION

Discover a curated selection of fine Ecuadorian and international wines, perfectly paired with your onboard culinary journey. Original Ecuadorian artworks throughout the yacht add sophistication and a refined sense of cultural identity.



FITNESS & MASSAGE ZONE

A versatile pop-up space for private workouts or massage sessions, available on request — allowing wellness to flow naturally with your journey.



HIGH-SPEED INTERNET

Stay effortlessly connected with complimentary Starlink high-speed Wi-Fi, available throughout the yacht.

YACHT OVERVIEW

	Type:	Mono hull steel explorer yacht
	Category:	Luxury
	Capacity:	16 Guests
	Crew:	15, including 2 naturalist guides
	Suites:	8
	Length:	42m. / 138ft.
	Width:	8m. / 26ft.
	Draft:	2.25m - 7.4ft
	Gross Tonnage:	380 GT
	Speed:	10 knots
	Year Built:	Guayaquil, Ecuador 2008
	Refurbished:	Guayaquil, Ecuador 2024-2025
	Refit Hull & Propulsion Design:	Tecnavin Naval Engineering
	Interior Design:	J. Vinueza Design
	Engines:	2x Baudouin 400 HP
	Generators:	2x Baudouin 91 kW
	Electricity:	110V / 220V
	Stabilizers:	CMC Marine
	Internet:	Starlink Satellite

Excursion equipment:

	2 Excursion Tenders
	4 Crystal tandem kayaks
	4 Crystal paddle boards
	Full snorkeling gear and wetsuits

Sailing Season: Operates year-round, offering exceptional wildlife encounters and immersive experiences in every season.

Child Policy: Children of all ages are welcome aboard. For a deeper, more engaging experience, we recommend participation for children aged **6 years and older**.

Dining: All meals are served with plated table service, featuring gourmet Ecuadorian and international cuisine. Breakfast includes select buffet items, fresh fruits, and daily specials.

** Please inform us of any dietary restrictions or preferences in advance.*

Onboard Payments

Payment Methods: Major credit cards accepted

Currency on board: US Dollar (USD)





INCLUSIONS

WHAT'S INCLUDED

Every journey aboard Galapagos Tribute is crafted to offer a truly exceptional and effortless experience. Your all-inclusive rate covers

- ✓ **Luxurious suite accommodation** with private facilities and ocean views.
- ✓ **All meals on board**, from lunch on embarkation day to breakfast on disembarkation day.
- ✓ **Selection of complimentary house beverages**, including Ecuadorian wines, local lager beer, and soft drinks.
- ✓ **Guided excursions** with two certified English-speaking naturalist guides (one guide for groups under 8 guests for FIT bookings / Cabin charter).

- ✓ **Use of one pair of binoculars per suite** for wildlife observation.
- ✓ **Aquatic exploration equipment**, including:
 - Tandem **kayaks and stand-up paddleboards**
 - Full **snorkeling gear** (mask, fins, snorkel)
 - **Wetsuits** (2.5mm, full-body)
- ✓ **Complimentary high-speed WiFi**, subject to connectivity in remote areas.
- ✓ **VIP airport lounge access** at Baltra (arrival & departure) and San Cristobal (departure only).
- ✓ **Ground transfers in Galapagos** between airport and yacht for guests arriving/departing on recommended flights

WHAT'S NOT INCLUDED

While we aim to provide a comprehensive and worry-free voyage, the following items are not included and should be arranged separately or in advance to ensure a smooth experience.

- × **Roundtrip airfare to the Galapagos Islands** from mainland Ecuador (Quito or Guayaquil).
- × **Galapagos National Park entrance fee:** USD 200 per person (subject to official updates).
- × **Transit Control Card (Migration control):** USD 20 per person (subject to change).
- × **Premium beverages**, including fine wines, spirits, and crafted cocktails (premium packages available).
- × **Boutique purchases** made on board.
- × **Gratuities** for the crew.
- × **Mandatory travel insurance** and any other personal expenses.

DEDICATED ADD-ON SERVICES



Private Photographer: Capture your journey with the dedicated services of a professional onboard photographer.



Nanny or Additional Hospitality Crew Member: Ensure peace of mind and added support for families or multi-generational charters.



Personalized Accommodations: Fine-tune your suite with custom bedding configurations and special preferences to match your comfort needs.



Premium Beverage Packages: Upgrade to curated drink selections or request bespoke spirits, wines, or non-alcoholic options tailored to your taste.



Adventure Add-Ons: Add optional experiences such as guided scuba diving or artisanal fishing excursions, available upon request.



Wellness Enhancements: Request private yoga sessions or massage therapy to unwind in total serenity against the backdrop of the islands.

DECK DISTRIBUTION

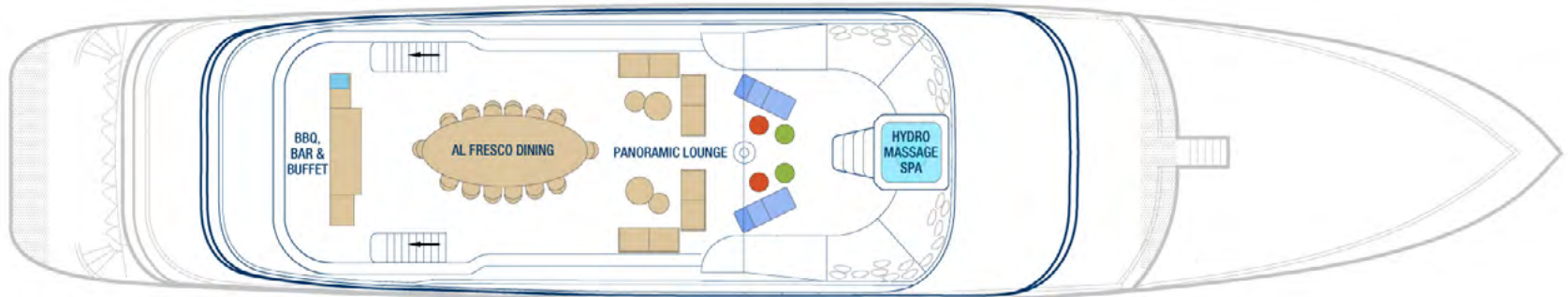

SKY DECK

- Al Fresco dining
- Open-air BBQ station
- Panoramic Lounge with shaded and sun-drenched zones
- Skyview hydro-massage spa

BRIDGE DECK

- Sunset lounge & marine wildlife observation
- Aft veranda lounge
- Pop-up workout zone & massage area
- 2 Premium suites and 2 Panorama suites

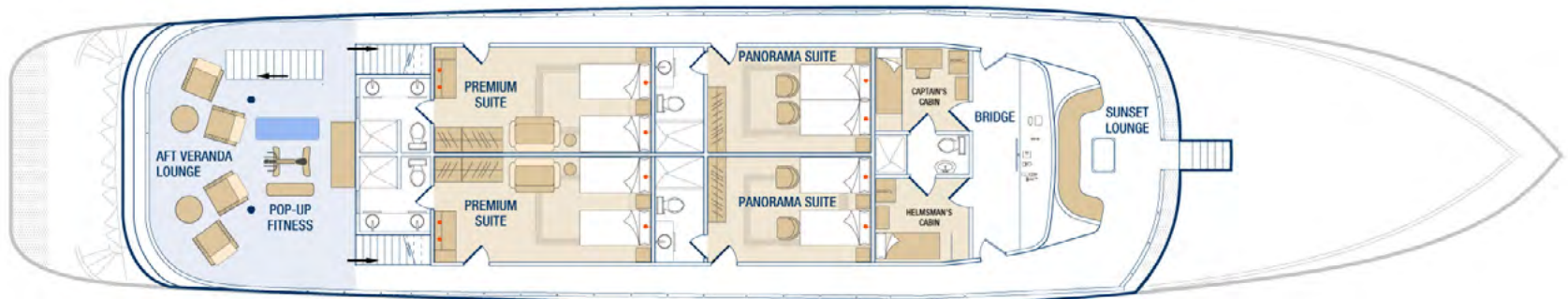

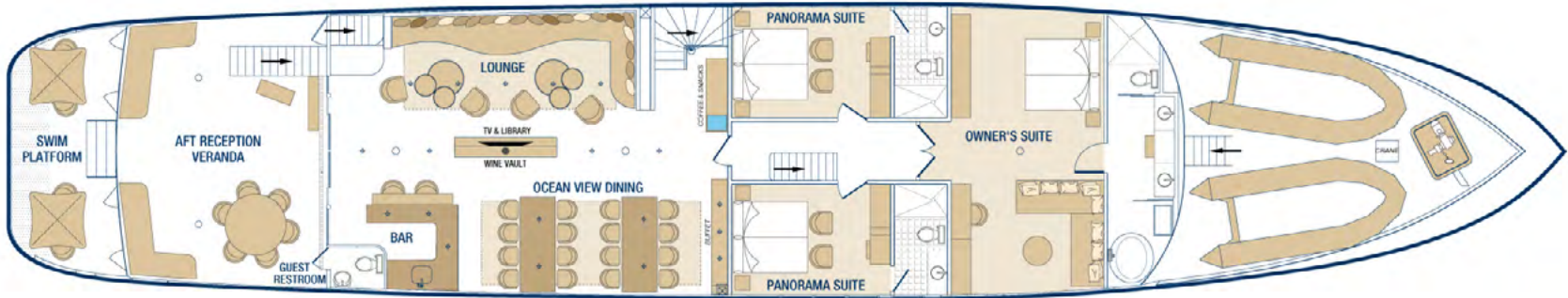

MAIN DECK

- Swim platform
- Aft reception veranda
- Guest restroom
- Cocktail bar & wine vault
- Coffee & Ecuadorian snacks corner
- Pop-up boutique
- Ocean view dining
- Freddy's lounge & library
- Owner's suite and 2 Panorama suites

OCEANSIDE DECK

- 1 Ocean Vista suite





SOCIAL AREAS

Sky Deck



- Panoramic Lounge with shaded and sun-drenched zones
- Skyview hydro-massage spa
- Al Fresco dining
- Open-air BBQ station

Bridge Deck



- Aft veranda lounge
- Pop-up workout zone & massage area
- Sunset lounge & marine wildlife observation

Main Deck



- Cocktail bar & wine vault
- Coffee & Ecuadorian snacks corner
- Pop-up boutique
- Ocean view dining
- Freddy's lounge & library



ACCOMMODATION

Owner's Suite

50 m² / 538 ft² – Main Deck (forward)

A sanctuary of privacy and comfort, the Owner's Suite is the most exclusive space aboard Galapagos Tribute. Located at the forward main deck, this full-beam suite features unobstructed ocean views on both starboard and port sides.

Designed for discerning travelers, it offers:

- King-size luxury bedding with pillow menu
- Spacious lounge with two plush sofas, coffee table, writing desk, and upholstered ottoman seat
- Ensuite spa-style bathroom with soaking tub, double vanity, ecosmart powder rain shower with dual jet settings, and premium amenities
- Custom climate control, electric blackout curtains, ample storage, bathrobes, and in-suite safe
- Espresso bar, satellite TV, binoculars, and refillable water bottles
- A locally sourced Ecuadorian artwork, reflecting the yacht's tribute to Ecuador's rich cultural heritage

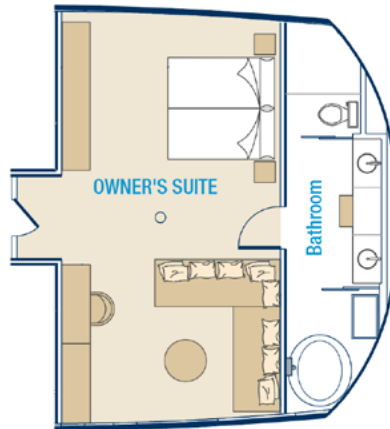

Maximum Suite Occupancy: 4 (3 adults + 1 Child)

Bedding: 1 King Size Bed | Option of 1 or 2 Additional Sofa Beds

Perfect for couples or families seeking ultimate space, privacy, and immersive views – a true expression of conscious luxury at sea.

Premium Suites

2 Suites – Bridge Deck | Approx. 25 m² / 269 ft²

Spacious, bright, and beautifully appointed, our Premium Suites deliver elevated comfort with panoramic views and thoughtful flexibility — ideal for couples or small families.

Features include:

- Sofa that converts into a third bed
- Superior foam mattress and ambient reading lights
- Double vanity ensuite bathroom with eco-smart powder rain shower and premium toiletries
- Custom climate control, electric blackout curtains, ample storage, bathrobes, and in-suite safe
- Espresso bar, binoculars, and refillable water bottles

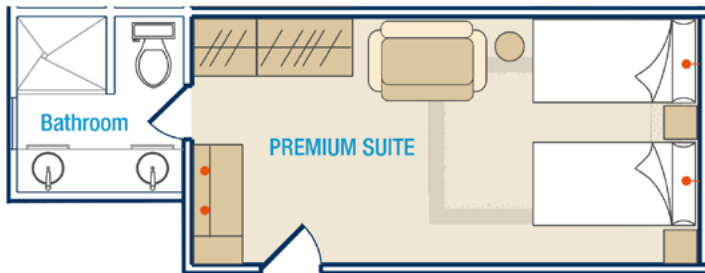

Convertible bedding: Two twin beds or one double bed + an additional Sofa Bed

Every detail is designed to enhance your journey — from rest to adventure — in effortless style.



Panorama Suites

4 Suites – 2 on Bridge Deck, 2 on Main Deck | Approx. 20 m² / 215 ft²

Modern and tranquil, our Panorama Suites offer intimate luxury with sweeping sea views and thoughtful Ecuadorian details — perfect for couples seeking a stylish and serene retreat.

Features include:

- Superior foam mattress, reading lights, and two comfortable lounge chairs
- Ensuite bathroom with eco-smart powder rain shower and premium toiletries
- Custom climate control, electric blackout curtains, proper storage, and in-suite safe
- Refillable water bottles

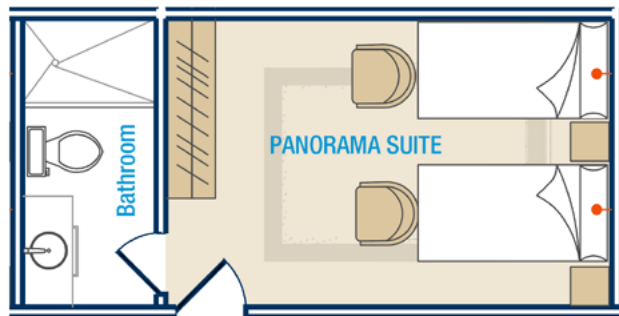

Convertible bedding: Two twin beds or one double bed

A well-appointed escape designed for rest, comfort, and panoramic connection to the islands.



Ocean Vista Suite

1 Suite – Oceanside Deck | Approx. 18 m² / 194 ft²

A serene and thoughtfully appointed retreat with three marine-view portholes, offering full functionality in a cozy setting.

Features include:

- Superior foam mattress and ambient reading lights
- Ensuite bathroom with eco-smart powder rain shower and premium bath amenities
- Custom climate control, ample storage, in-suite safe, and refillable water bottles



Convertible bedding: Two twin beds or one double bed

An excellent choice for solo travelers or value-savvy couples seeking comfort, privacy, and immersive exploration.

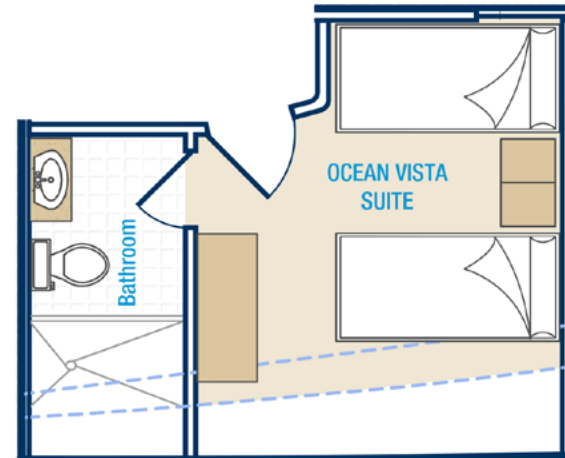

SUITE CATEGORY OVERVIEW

FEATURE	Owner's Suite	Premium Suite	Panorama Suite	Ocean Vista Suite
Number of Suites	1	2	4	1
Deck Location	Main Deck	Bridge Deck	Main (2), Bridge (2)	Oceanside Deck
Size	50 m ² / 538 ft ²	25 m ² / 269 ft ²	20 m ² / 215 ft ²	18 m ² / 194 ft ²
Windows	Yes	Yes	Yes	No
Portholes	No	No	No	Yes
Bed Size	King (200 × 193 cm / 79" × 76")	Twin (200 × 96.5 cm / 79" × 38")	Twin (200 × 96.5 cm / 79" × 38")	Twin (200 × 96.5 cm / 79" × 38")
Twin Bed Option	No	Yes	Yes	Yes
Double Bed Option	Yes	Yes	Yes	Yes
Sofa Bed	Yes (190 × 90 cm / 75" × 35")	Yes (190 × 90 cm / 75" × 35")	–	–
Second Sofa Bed	Yes (160 × 90 cm / 63" × 35", child only)	–	–	–
Max Occupancy	4	3	2	2
Single Occupancy	100% surcharge	100% surcharge	80% surcharge	80% surcharge
Triple Occupancy	Yes	Yes	No	No
Quadruple Occupancy	Yes	No	No	No
Electricity	110V / 220V	110V / 220V	110V	110V
Air Conditioning	Yes	Yes	Yes	Yes
En Suite Bathroom	Yes	Yes	Yes	Yes
Massage Shower	Yes	Yes	Yes	Yes
Eco-Flush Toilet	Yes	Yes	Yes	Yes
Private Bathtub	Yes	–	–	–
Bathrobes	Yes	Yes	–	–
Bath Amenities*	Yes	Yes	Yes	Yes
Hair Dryer	Yes	Yes	Yes	Yes
Safe	Yes	Yes	Yes	Yes
Water Bottle (Refillable)	Yes	Yes	Yes	Yes
In-Suite Espresso Bar	Yes	Yes	–	–
Binoculars for Excursions	Yes	Yes	–**	–**
Pillow Menu	Yes	–	–	–
Satellite TV	Yes	–	–	–
Complimentary Laundry	Yes	–	–	–

Notes: *Bath amenities include eco-friendly toiletries. / **Binoculars available upon request for shared use.



EXPERIENCE

Experiences Aboard Galapagos Tribute

Every journey aboard Galapagos Tribute is a carefully curated immersion into the wild heart of the Galápagos — blending exploration, education, and Ecuadorian elegance.



Guided Interpretation Walks on Trails & Pristine Beaches

Step ashore on iconic islands and hidden gems alongside expert naturalist guides. Discover fearless wildlife, volcanic landscapes, and fragile ecosystems on curated paths, enriched with insightful interpretation and storytelling.



Scenic Dinghy Rides with Expert-Led Wildlife Encounters

Glide through mangroves, coastal cliffs, and turquoise inlets aboard our custom tenders. Your guides will reveal hidden species and unique behaviors up close, from blue-footed boobies to lounging marine iguanas.



Birdwatching & Marine Life Spotting (with Personal Binoculars)

Observe rare endemic species and Galápagos icons — from waved albatross to sea lions and reef sharks — with your own high-end binoculars available for exclusive guest use.

Fascinating Briefings & Lectures with Naturalist Experts

Engage with daily onboard talks that transform your cruise into a floating classroom, deepening your understanding of the islands' extraordinary evolution, wildlife, and conservation.



Snorkeling in Marine Sanctuaries

Dive into underwater worlds teeming with life: sea turtles, playful sea lions, rays, reef fish, and the occasional Galápagos penguin await in the archipelago's crystal-clear waters.

Leisurely Swimming in Protected Bays

Enjoy tranquil swims in shallow lagoons and serene beaches, carefully selected for safety and wildlife proximity.





Sea Kayaking Adventures

Paddle through calm coastal zones and secluded coves, offering a peaceful, low-impact way to witness wildlife from the water's surface — ideal for intimate moments with nature.



Stand-Up Paddleboarding (SUP)

Glide silently over reef-lined shores and marine landscapes. A fun and serene way to explore while staying active and connected with the surroundings.



Stargazing & Celestial Interpretation

On clear nights, lie back on the open deck for guided stargazing experiences. Learn ancient navigation stories and identify southern constellations under unspoiled skies.



Ecuadorian Fine Cocoa Tasting

Discover the richness of fino de aroma — one of the world's finest cacao varieties — in a curated chocolate tasting that connects you to Ecuador's aromatic heritage.

Ecuadorian Wine & Sustainable Produce

Delight in a curated selection of boutique Ecuadorian wines, artisanal cheeses, and sustainably sourced local ingredients. These sensory experiences celebrate Ecuador's emerging culinary identity, offering a tasteful journey into the country's rich flavors and commitment to conscious gastronomy.



Signature Farewell Ecuadorian Tasting Dinner

Savor a memorable final evening with a multi-course tasting menu — a celebration of local flavors, ingredients, and culinary artistry, set beneath the stars.



ITINERARIES FOR YOU

ENCHANTED ESCAPE

5 Days / 4 Nights Aboard the Galapagos Tribute – Wednesday to Sunday

Embark on a refined journey through the heart of the Galapagos, where every moment is crafted for travelers seeking authenticity, comfort, and extraordinary natural encounters. This five-day expedition aboard the Galapagos Tribute reveals a curated selection of the archipelago's most enchanting sites—each offering a distinct window into its geological wonders and iconic wildlife.

Begin among giant tortoises in the lush highlands of Santa Cruz, then stroll the white sands of Mosquera Islet, where sea lions and coastal birds thrive. Explore the surreal terrain of South Plaza, home to vivid groundcover and prehistoric-looking land iguanas, before snorkeling the crystalline waters of Champion Islet or kayaking near Baroness Lookout on Floreana Island. Visit the historical Post Office Bay, then venture to Española Island for breathtaking cliffside views, albatross colonies, and the unforgettable blowhole at Punta Suarez. Conclude your voyage on San Cristobal Island, where conservation and discovery meet at the Interpretation Center—a fitting finale to this unforgettable escape.



DAY 1 Wednesday

Arrival in the Galapagos & Santa Cruz Highlands

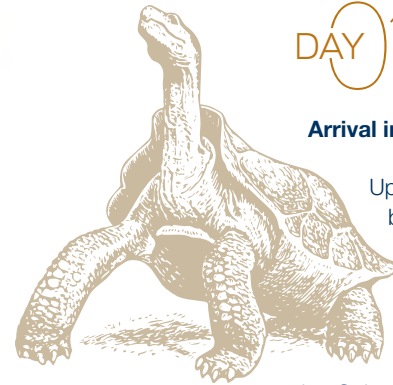

Upon arrival at Baltra Airport, you'll be greeted by the Oniric Cruises team and assisted through entry procedures, including registration of your Transit Control Card and payment of the Galapagos National Park fee, if not pre-arranged. Enjoy a brief transfer to the harbor, where the Galapagos Tribute awaits. Meet the captain and crew, settle into your elegant suite, and savor your first gourmet lunch on board.

In the afternoon, venture into the lush highlands of Santa Cruz Island, home to wild Galapagos giant tortoises. Walk among these ancient creatures and explore the volcanic landscapes of the El Chato Reserve, where you may also spot native birdlife such as the vermilion flycatcher and Galapagos rail.

DAY 02 Thursday

Mosquera Islet & South Plaza Island

Begin your day on Mosquera Islet, a white coral sandbar between Baltra and North Seymour. Watch sea lions basking along the shore, spot sanderlings and lava gulls, and photograph vivid Sally Lightfoot crabs on black lava rocks. Optional snorkeling offers sightings of reef fish, rays, and white-tipped sharks.

In the afternoon, explore South Plaza, a small but visually stunning island with bright groundcover, prickly pear cacti, and dramatic cliffs. Observe land iguanas, red-billed tropicbirds, and swallow-tailed gulls in this prehistoric-looking habitat.

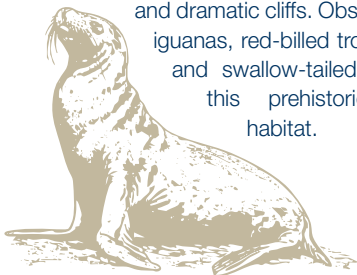

DAY 03 Friday

Floreana Island: Cormorant Point, Champion Islet, Post Office Bay & Baroness Lookout

Disembark on Floreana at Punta Cormorant to walk from a green olivine beach to a contrasting white coral beach—seasonal nesting grounds for Pacific green sea turtles. Snorkel off nearby Champion Islet, home to tropical fish, sea lions, and possibly the elusive Floreana mockingbird.

After lunch, continue to Post Office Bay, where you can take part in a centuries-old mariner tradition. Then kayak along the shoreline or snorkel in tranquil waters, keeping an eye out for turtles, penguins, and rays. End with a short hike to Baroness Lookout for panoramic coastal views.



DAY 04 Saturday

Española Island: Punta Suarez & Gardner Bay

Arrive at Punta Suarez, one of the archipelago's top wildlife destinations. Encounter blue-footed and Nazca boobies, Española mockingbirds, Galapagos hawks, and, seasonally, the remarkable waved albatross. Follow the trail past lava formations to "El Soplador," a dramatic blowhole where waves explode through a lava tunnel.

In the afternoon, unwind on the white sands of Gardner Bay, where sea lions lounge and turquoise waters invite you to snorkel or kayak among rays, reef sharks, and graceful sea turtles.



DAY 05 Sunday

San Cristobal: Interpretation Center & Frigatebird Hill

Disembark on San Cristobal Island for a visit to the Galapagos Interpretation Center, where thoughtfully curated exhibits offer insights into the islands' ecology, geology, and conservation.

After the visit, you'll be transferred to the San Cristobal airport for your return flight to mainland Ecuador, bringing to a close your unforgettable journey aboard the Galapagos Tribute.

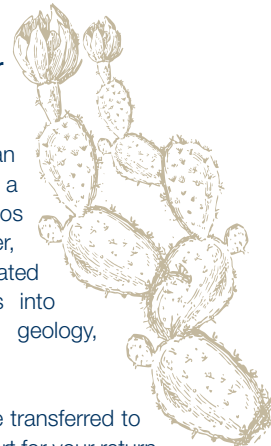

5D/4N Enchanted Escape - Itinerary Overview

HIGH CHANCE OF SPOTTING:



Great and Magnificent frigatebird



Waved Albatross

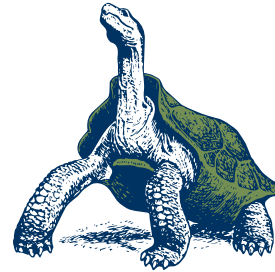

Galapagos Giant Tortoise

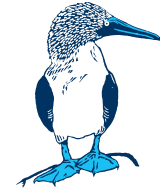

Boobies Colonies



Sea Lion



Galapagos Marine Iguana

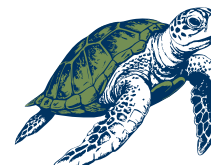

Sea Turtle

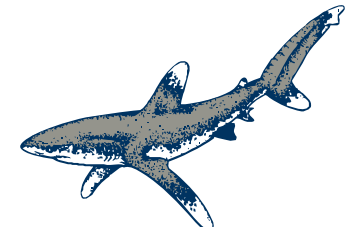

Whitetip Reef Shark

DAY 02 Monday

Santa Fe Island & Black Turtle Cove (Santa Cruz)

Santa Fe Island greets you with its dramatic stands of giant prickly pear cacti, silhouetted against the sea. Hike a trail through this otherworldly landscape in search of Santa Fe land iguanas, Galapagos hawks, and curious sea lions. In Barrington Bay, snorkel in crystalline waters alongside stingrays, turtles, and white-tipped reef sharks—or paddle a kayak along the coastline, discovering lava formations and hidden marine life.

Later, explore Black Turtle Cove by dinghy—a serene mangrove lagoon rich in wildlife. Navigate slowly through still waters as Pacific green turtles, eagle rays, and baby reef sharks glide silently beneath the surface. This protected cove is a vital nursery for marine species and a haven for birdwatchers and photographers.

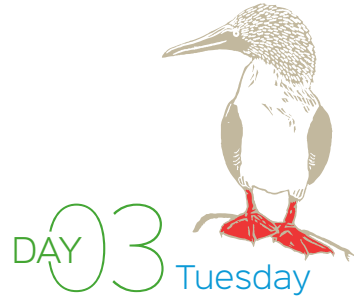

DAY 03 Tuesday

Darwin Bay & Prince Philip's Steps (Genovesa Island)

Wake to the secluded volcanic walls of Genovesa, a caldera haven in the remote north. At Darwin Bay, walk along a coral sand beach bordered by mangroves, where red-footed boobies nest above, and sea lions rest along the tide line. Spot yellow warblers and finches before taking to the water for a snorkel or kayak session—hammerhead sharks, jacks, and green turtles are often seen here.

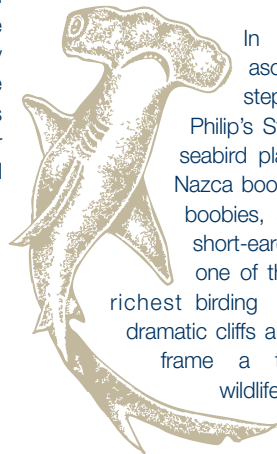

In the afternoon, ascend the lava steps at Prince Philip's Steps to reach a seabird plateau alive with Nazca boobies, red-footed boobies, and the elusive short-eared owl. This is one of the archipelago's richest birding sites, where dramatic cliffs and ocean vistas frame a truly cinematic wildlife encounter.

DAY 04 Wednesday

Chinese Hat & Rabida

This morning, visit Chinese Hat, a young volcanic islet with lava fields colonized by pioneer vegetation. Encounter sea lions, marine iguanas, and Galapagos hawks along the trail, then snorkel in clear, protected waters alongside penguins, sea turtles, and rays. The intricate underwater terrain of lava tunnels and coral beds makes this a top snorkeling site.

In the afternoon, Rabida Island enchants with its red sand beach and surreal landscape. Brown pelicans nest in nearby mangroves, and American flamingos may be seen feeding in a brackish lagoon inland. Snorkel just offshore to observe parrotfish, rays, and reef sharks, or kayak along the coppery coast past sculpted lava cliffs and hidden caves.



DAY 05 Thursday

Charles Darwin Research Station (Santa Cruz Island) & Departure

Conclude your journey with a visit to the Charles Darwin Research Station in Puerto Ayora. Stroll through native gardens and observe giant tortoises at various life stages in the breeding center—icons of the Galapagos and vital symbols of ongoing conservation. After your visit, transfer across Santa Cruz Island to Baltra Airport for your return flight, departing with a deeper understanding of the Galapagos legacy—and your place in preserving it.

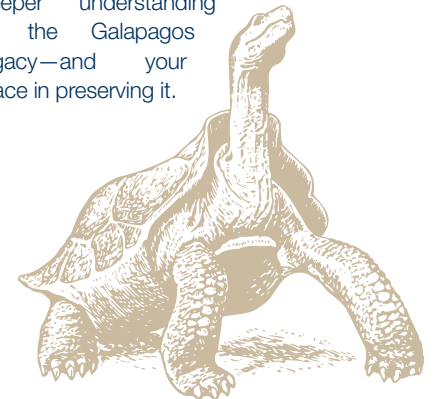

5D/4N Wildlife Discovery - Itinerary Overview

HIGH CHANCE OF SPOTTING:

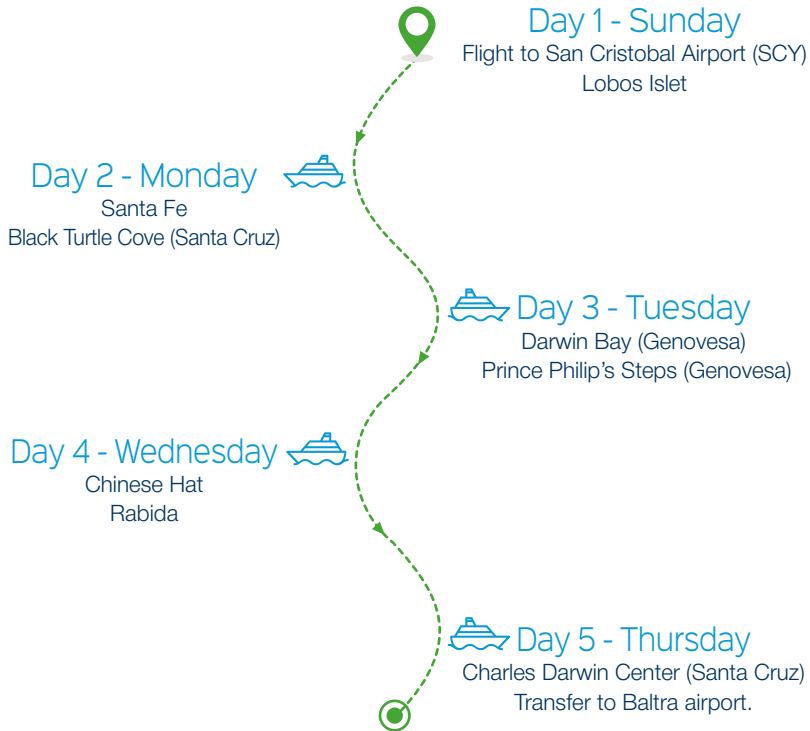

DARWIN'S ODYSSEY

7 Days / 6 Nights Aboard the Galapagos Tribute - Thursday to Wednesday

Venture into the evolutionary heart of the Galapagos on this extraordinary week-long odyssey—an immersive expedition designed for those who seek deeper meaning in exploration. From the volcanic majesty of Isabela and Fernandina to the remote shores of Bartholomew, Santiago, and Genovesa, this journey traces the path of natural history itself. Experience up-close wildlife encounters, dramatic geological formations, and moments of quiet wonder—each day curated with precision and delivered in effortless luxury aboard the Galapagos Tribute.

Walk among giant tortoises in the highlands of Santa Cruz, hike the vast caldera of Sierra Negra, kayak beside nesting penguins at Tagus Cove, and snorkel with marine iguanas, turtles, and reef sharks in the remote western waters. From flamingo-lined lagoons to iconic Pinnacle Rock, and from lava flows to land iguanas and seabird colonies, this is Darwin's legacy brought vividly to life.



DAY 01 Thursday

Arrival at Baltra Airport & Santa Cruz Highlands

Your adventure begins upon arrival at Baltra Airport, where you'll be greeted by the Oniric Cruises team. After assistance with Galapagos entry formalities, including Transit Control Card registration and the National Park entrance fee (if not pre-arranged), a short transfer brings you to the harbor. Board the Galapagos Tribute and enjoy a warm welcome from the crew, a gourmet lunch, and your first sea views.

In the afternoon, venture into the verdant highlands of Santa Cruz Island. Walk through the El Chato Reserve, where giant tortoises roam freely among misty pastures and lava tunnels. Vermilion flycatchers and Darwin's finches may accompany your stroll through this peaceful, high-altitude ecosystem.

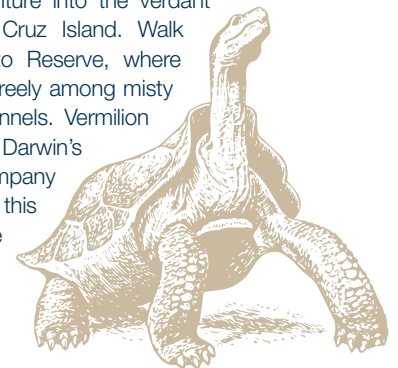

DAY 02 Friday

Isabela Island: Tintoreras, Sierra Negra Volcano & Wetlands

Start your day at Tintoreras Islet—home to marine iguanas, Galapagos penguins, and white-tipped reef sharks resting in shallow crevices.

Later, ascend into the highlands to explore the immense caldera of Sierra Negra Volcano, with views over one of the widest craters in the world. Hike through zones of endemic vegetation and stark lava fields, encountering lava lizards, mockingbirds, and giant Opuntia cacti.

In the afternoon, visit the wetlands near Puerto Villamil. A network of trails and lagoons reveals flamingos, black-necked stilts, and pintail ducks. End the day at the Tortoise Breeding Center, where endangered species are nurtured and protected in various life stages.



DAY 03 Saturday

Isabela & Fernandina Islands: Moreno Point & Espinoza Point

At Moreno Point on Isabela's western coast, trek across solidified lava fields where brackish lagoons serve as habitats for flamingos, pintail ducks, and marine turtles. Then snorkel in clear waters populated by rays, sea turtles, and vibrant reef fish.

Cross to Fernandina Island—among the most untouched ecosystems on Earth. At Espinoza Point, witness marine iguanas basking by the hundreds, Galapagos hawks soaring above, and the flightless cormorant drying its stubby wings. Snorkeling here offers chances to swim with sea turtles, sea lions, and even penguins beneath the gaze of La Cumbre Volcano.

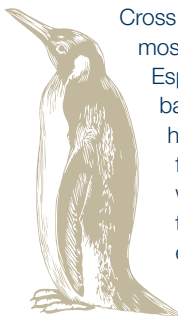

DAY 04 Sunday

Isabela Island: Tagus Cove & Vicente Roca Point

Cruise into historic Tagus Cove, once frequented by whalers and pirates. A scenic trail leads to Darwin Lake, with panoramic views and 19th-century graffiti etched into volcanic walls. Kayak or snorkel along the shoreline, where penguins, cormorants, and marine turtles often appear.

In the afternoon, visit Vicente Roca Point—an eroded volcanic amphitheater alive with seabirds and marine life. Snorkel in deep, nutrient-rich waters that attract sunfish (Mola mola), seahorses, rays, and sharks in a kaleidoscopic display of underwater biodiversity.

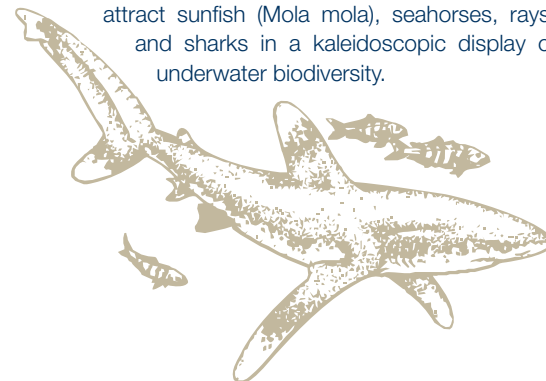

DAY 05 Monday

Bartholomew Island & Sullivan Bay (Santiago)

Climb the summit trail of Bartholomew Island for iconic views over Pinnacle Rock and Santiago Island's black lava fields. Along the way, observe pioneer vegetation like lava cactus reclaiming the young volcanic soil.

In the afternoon, walk the rippled lava terrain of Sullivan Bay—a landscape frozen in time by a 19th-century eruption. Then snorkel in surrounding waters inhabited by Galapagos penguins, reef sharks, and Pacific green turtles.

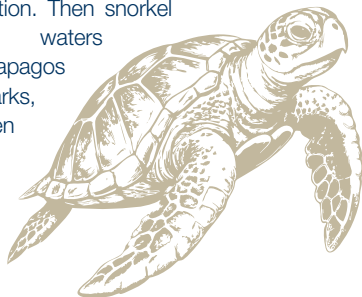

DAY 06 Tuesday

Santa Cruz & North Seymour Islands: Dragon Hill & Seabird Colonies

Explore Dragon Hill, where land iguanas roam among palo santo trees and cactus thickets. Nearby saltwater lagoons offer sightings of flamingos, herons, and black-necked stilts. From the trail's summit, enjoy panoramic views of the island's rugged coastline.

Later, visit North Seymour Island, one of the most vibrant wildlife sites in the Galapagos. Walk among blue-footed boobies performing courtship dances, male frigatebirds inflating their crimson pouches, and sea lions lounging beside your path. Snorkeling here reveals schools of colorful fish, rays, and reef sharks.



DAY 07 Wednesday

Bachas Beach (Santa Cruz) & Departure from Baltra

Begin your final morning at Bachas Beach, a serene cove where sea turtles nest and flamingos wade through tranquil lagoons. Stroll along white sands past remnants of World War II-era barges now reclaimed by nature.

After your visit, transfer to Baltra Airport for your return flight to the mainland—carrying with you the memory of an extraordinary journey through fire-forged landscapes and thriving life.

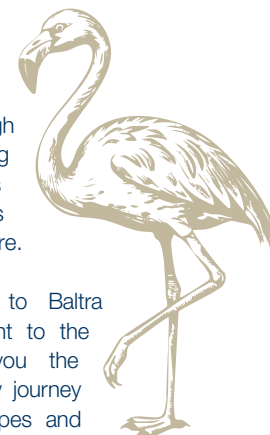

7D/6N Darwin's Odyssey - Itinerary Overview

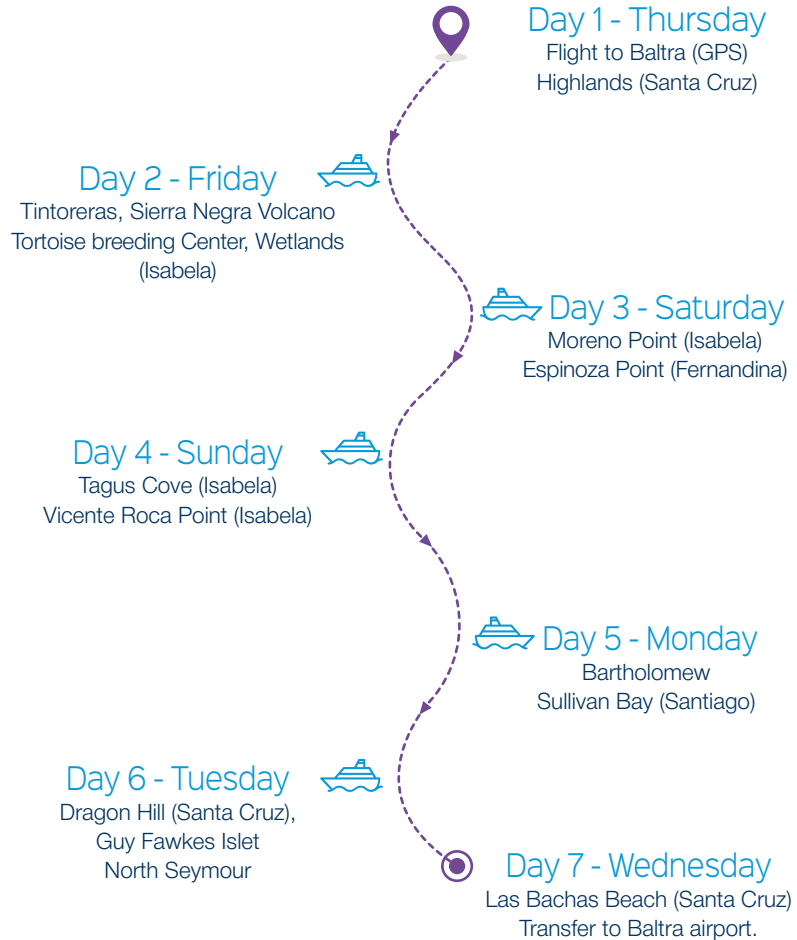

HIGH CHANCE OF SPOTTING:



Great and Magnificent frigatebird



Flightless Cormorant

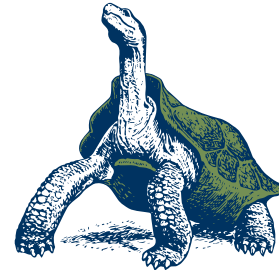

Galapagos Giant Tortoise

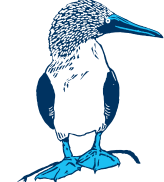

Boobies Colonies



Sea Lion



American Flamingo

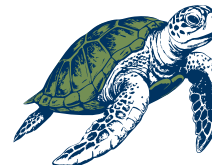

Sea Turtle



Land Iguana



YOUR VOYAGE. THEIR FUTURE. OUR **TRIBUTE.**

